

# MiSign Suite Trio



*“Emulating existing paper and INK Processes digitally offline, on your Smartphone or Tablet”*

- Customise and Integrate into your own eMobile Business Solution, and or Build one.
- Develop In House and or Outsource to the MiSign Team.
- Highly secure mobile device capture control, with full biometric and digital evidence capture options.
- Maximise Biometric Data Capture, with a Bluetooth Pen Pressure Stylus. (Ideal for Asian Characters)
- Documents are locked and protected via a cryptographic hash to prevent fraud.
- Supports 13 different languages. If the OS target language is not available, it defaults to English.
- Wide Stylus Selection: iOS, Bamboo Stylus Finition, Bamboo Finition 2, Intuos Creative Stylus, Intuos Creative Stylus 2 which are designed for use with iPads including iPad Mini 1,2 and 3, iPad 3 and 4, iPad Air 1 and 2. For Android, Samsung Galaxy Note series and Tablets that make use of Wacom EMR technology.

*“Available Pay by the Month or One Time Purchase”*

*“Creating and Signing eSignature enabled documents, wherever you are.”*

*“Multiple Digital Signature Types:*

*Handwritten Biometric, eSeal, Graphic, PKI, Digital Signature, including combinations for the same Signor”.*

*“Mix Signature Types on the same document”.*

*“Use your Finger, Generic Stylus or Wireless Pen Pressure Stylus”.*

*“The captured signature data remains securely embedded, inside the document, as an encrypted blob, for the lifetime of the document”.*

*“Content hash, Per Signor, Digital and Biometric Evidence Captured Dynamically at time of Signing in one Natural Transparent Process”*

*“Sign any Document Type”*

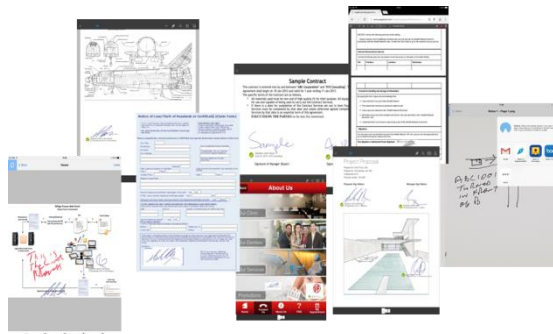

*“Multi Country Legal Digital Signature Type”*

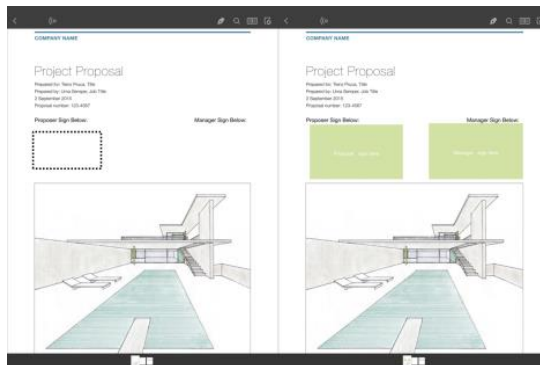

*“Drag and Drop Ad Hoc or Fix Signature Capture areas with Signor Rules”*

**“Features”**

- ✓ Small file sizes, ideal for mobile.
- ✓ Original kept secure only copies emailed.
- ✓ Can be used for eMobile signature capture only.
- ✓ Annotation
- ✓ Form Filling
- ✓ PDF/A Compatible
- ✓ Fully customisable.
- ✓ Can be tightly integrated into existing applications.

**“Benefits”**

- ✓ Save on paper document delivery, storage and courier costs.
- ✓ Save on travelling time.
- ✓ Sign wherever you are.
- ✓ Deploy faster and with less ongoing maintenance and support.
- ✓ Work how and when you want offline.



*“Meeting Tomorrow’s eSignature Workflow needs Today”*



**IOS 8.0 or Later, Android OS 4.4.2 or later**

Typical Offline with Local DB Process and Options

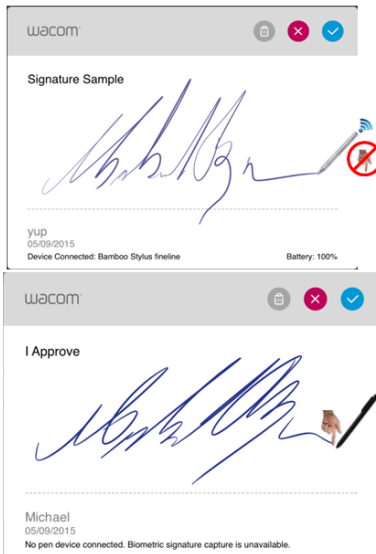
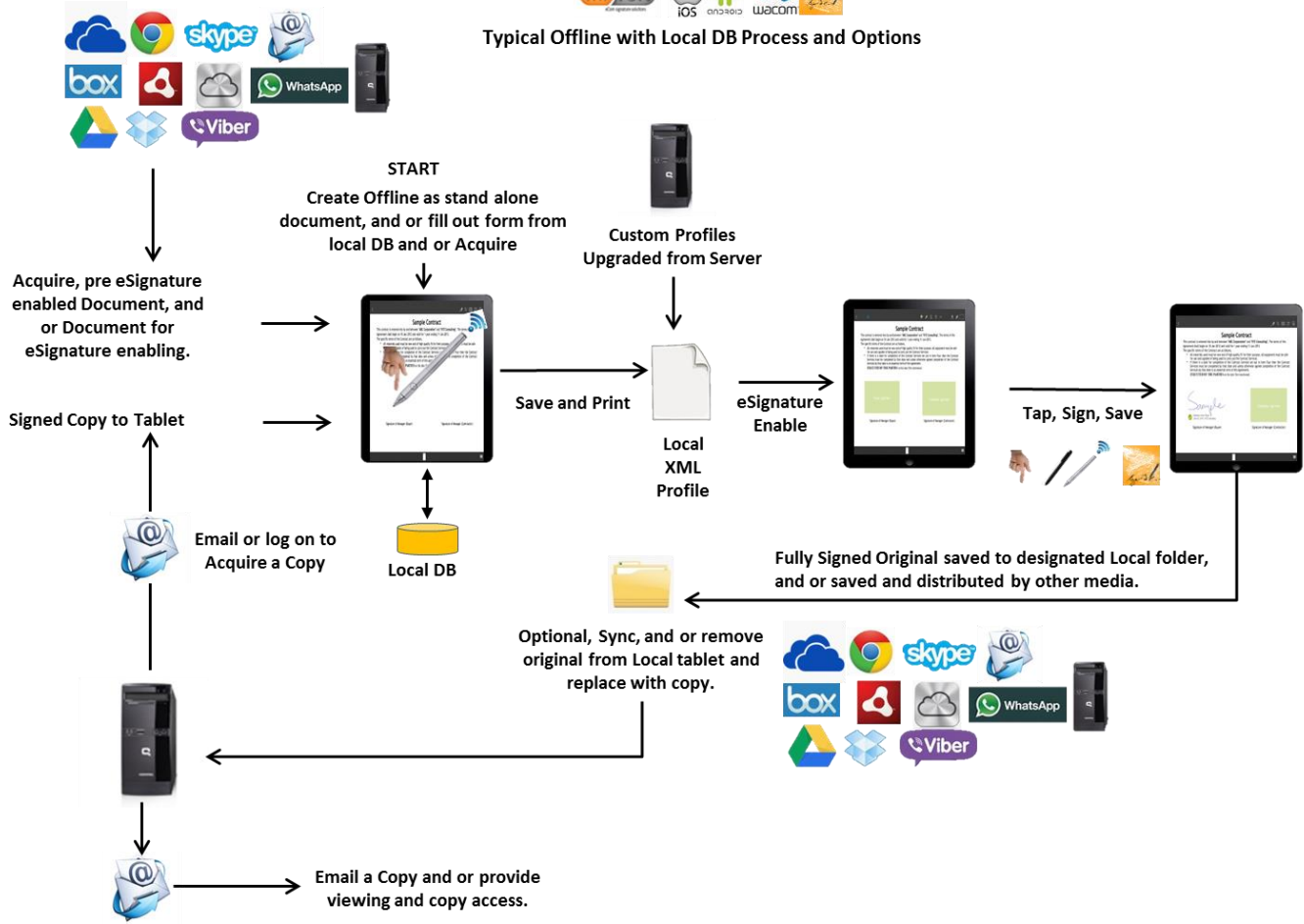

Highest Level Biometric Data Captured, High Level Digital Evidence. Including visible pen pressure display

The Wacom Capture Controls include the latest drawing rendering technology.

The Wacom Ink Layer Language (WILL) is a universal inking engine and ink layer framework which connects hardware, software and applications. WILL is a technology that enables high quality digital pen and ink experience.

Very Low Level Biometric Data Captured, High Level Digital Evidence

"Smart XML Document Profiles, manage user security, document preferences, digital signature type, business rules and auto signature box placement"

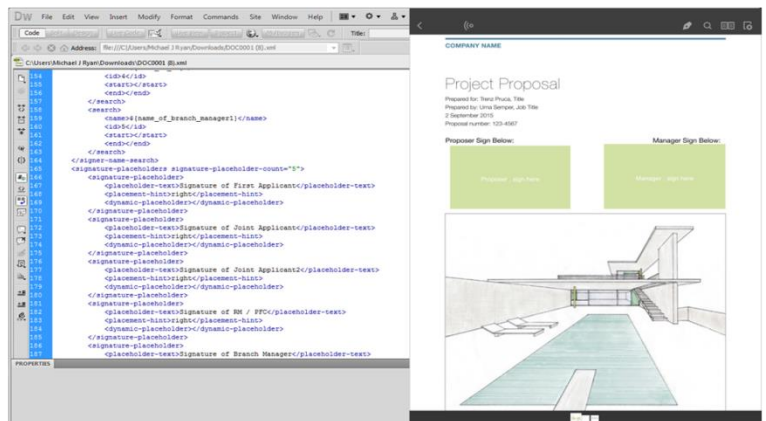

"Unlimited profiles per user and document type"

**"With TRIO'S wide choice of Digital Signature Types, Signature Capture Methods, Advanced Technology, Acquire and Distribution Options and Straight Forward Integration Capability, it is the eMobile eSignature Enabling Product of Tomorrow".**

Contact [Sales@misignhub.com](mailto:Sales@misignhub.com) for all enquiries